

KING
Solution Corp.

Low Pressure Molding
An innovative process:
20~500psi(1.5~30Kgf/cm²)
To replace the epoxy potting
for protection of fragile
electronic components.



Dual Injection

Low Pressure Molding Machine



Dual Injection Low Pressure Molding Machine

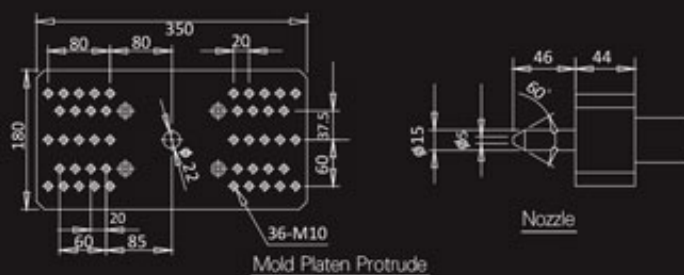
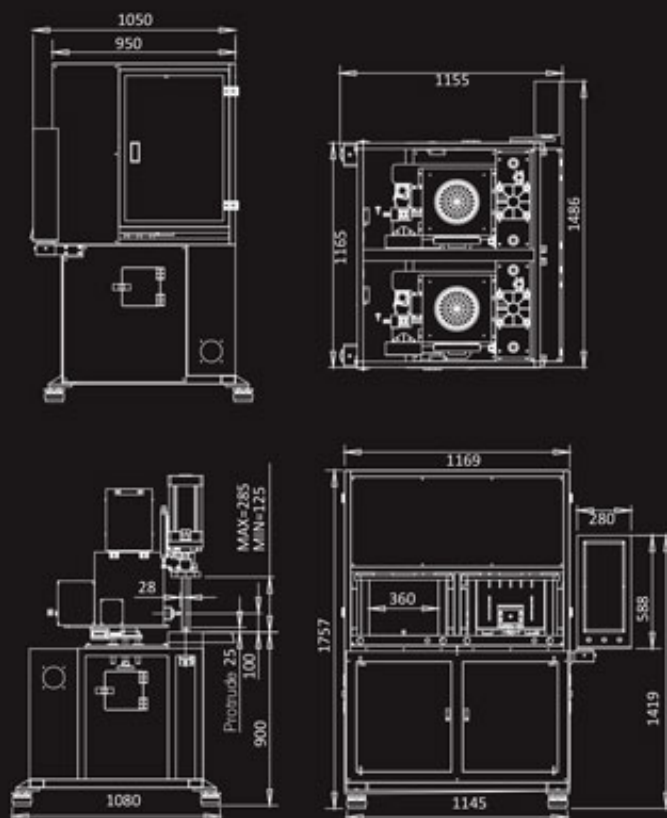

- Machine driven by pneumatics and servo motor, energy saving, low pollution and no oil leakage, suitable for clean room and laboratory.
- The Pressure adjusting valve control the pressure of injection.
- TWO PID thermal temperature control zones (Melting tank and nozzle).
- Teflon coated melting tank made from Aluminum alloy, heated evenly & rapidly, much easier to clean.
- Nozzle connected to melting tank, injection unit driven by air pressure.
- Nozzle directly connected to gear pump and no heating pipe, avoid crystallization.
- Two tie-bar design for molding small parts, operation easily.
- Sealing cover, Safety Light curtain, pneumatic door and dual palm safety button for personnel safeguard.
- Multi-Language PC Base industrial type Linux core system.
- 1000 sets of mold settings can be stored and export as backup.
- Complete record of history settings & warnings. Built in USB connect.
- On-line control and maintenance service.

Model		KL-WVH-01-2-09-2-1	
INJECTION UNIT			
Injection Type		Horizontal injection from parting line	
Capacity	L	3.5 x 2	6.5 x 2
Injection Capacity	ml/r	8.98	
Pump Speed	r.p.m.	0~100	
Nozzle Stroke	mm	50	
Nozzle Contact Force	Tf	0.06	
CLAMPING UNIT			
Clamping System		Pneumatic	Air Booster
Clamping Force	Tf	1 x 2	4 x 2
Opening Stroke	mm	160	
Mould Space	mm	285	
Min Mould Space	mm	125	
Overall Size of Platens	mm	400*150	
Space Between Columns	mm	360	
Size Of Shuttler Platen	mm	350*150	*Optional
Shuttle Plate Stroke	mm	200	*Optional
Ejector		Pneumatic	
Ejector Force	Tf	0.12	
Ejector Stroke	mm	(UP) 25	
ELECTRICAL EQUIPMENT & GENERAL			
Power Source / Voltage	V/Hz	1ϕ-220v (60Hz / 50Hz)	
Drive Motor	KW	0.4 x 2	
Heater	KW	4.5 x 2	
Temperature Control Zone	ZONE	3	
Hydraulic System Pressure	kgf/cm²	6	
Machine Dimension	m	1.45*1.05*1.75	
Machine Weight	ton	0.9	

KING'S Solution Corp.

Taiwan : No.457, Nanshang Rd., Guishan Dist, Taoyuan City 33392, Taiwan | sales@kingsmachinery.com.tw | Tel : +886-3-3218768 | Fax : +886-3-3218769
 China : Bao Xin Industrial Park, Wu Village, Chen Jiang Town, Hui Zhou City, Guangdong, China | Tel : +86-752-3269005/07 | Fax : +86-752-3269360/350
www.injection.com.tw/ | www.facebook.com/Kingsmachinery/ | <https://www.youtube.com/user/kingsmachinery/>

